

abbotFox



West Norwich, NR5
£1,450 PCM

“

We are a team of genuine individuals who hold a deep passion for both property and marketing. Collectively, we bring over 70 years of experience in the property market of Norfolk and Suffolk. Our affection for both counties runs deep, and we are enthusiastic about sharing our passion with you.

Colin McKenzie | **Branch Partner**







THE DETAIL_____

abbotFox are pleased to present this deceptively spacious five/six bedroom end terrace with accommodation arranged over three floors.

Accommodation comprises; entrance hall, sitting room/bedroom with wood burning stove and en suite shower room, cloakroom, kitchen breakfast room and a conservatory/utility room.

The first floor provides three bedrooms and a large four piece family bathroom suite.

Two further bedrooms can be found on the second floor.

Outside, the property features an enclosed, front and rear garden and two allocated car parking spaces.







THE HIGHLIGHTS__

- A versatile five/six bedroom home
- Two allocated car parking spaces
- Front and rear gardens
- Kitchen breakfast room

GROUND FLOOR
22.9 sq.m. (659 sq.ft.) approx.



1ST FLOOR
41.6 sq.m. (448 sq.ft.) approx.

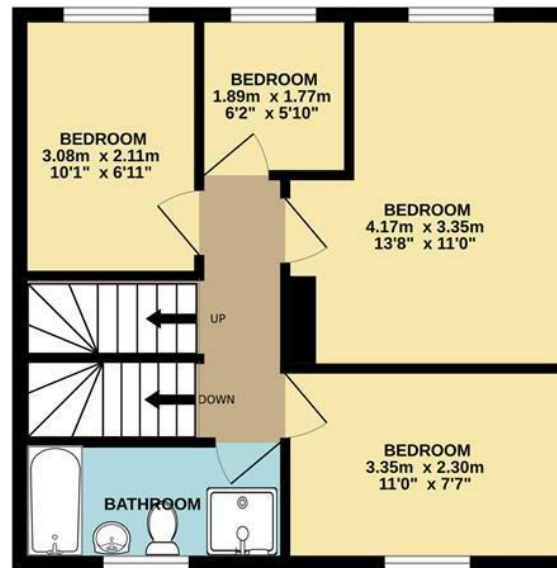

2ND FLOOR
22.9 sq.m. (246 sq.ft.) approx.

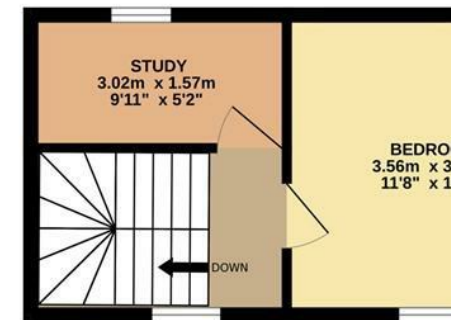

TOTAL FLOOR AREA : 125.7 sq.m. (1353 sq.ft.) approx.

Whilst every attempt has been made to ensure the accuracy of the floorplan contained here, measurements of doors, windows, rooms and any other items are approximate and no responsibility is taken for any error, omission or mis-statement. This plan is for illustrative purposes only and should be used as such by any prospective purchaser. The services, systems and appliances shown have not been tested and no guarantee as to their operability or efficiency can be given.

Made with Metropix ©2023

Let's talk

01603 660000

sales@abbotfox.co.uk

@abbotfox

EPC RATING - C

Disclaimer – In accordance with the Property Misdescriptions Act, the company abbotFox gives notice that all descriptions, references to condition, necessary permissions for use and other details are given in good faith and believed to be correct, but any purchaser should not rely on them as statements of fact, and must satisfy themselves by inspection or other means, as to their accuracy.